

HISTORIC PRESERVATION ELEMENT

Chatham Township's history reflects the physical character of the town and explains the settlement patterns leading to the present day.

BRIEF HISTORY

Chatham Township's rich natural resources shaped its history. In pre-colonial times, the Leni Lenape Indians used the Great Swamp and the Passaic River as summer hunting and fishing grounds. In the 1700's colonial settlers gradually arrived, building farms scattered along the Passaic River and in Green Village on either side of the swamp. Green Village is described as an industrial village by the Morris County Heritage Commission - it boasted a basket making factory, blacksmith's shop, mills and scattered 18th century houses. During the Revolutionary War, evidence indicates that George Washington's troops encamped in the northerly part of the town and that during an outbreak of small pox, that the sick were taken in by villagers. Green Village has the potential for qualification as a historic district.

Littell's 1845 map of the Passaic Valley shows a survey done of the area by William Penn. Being an important source of lumber, the swamp was divided into wood lots for the purposes of tree harvesting, with lot 1 being the present day Green Village Post Office.

One historic site, the Boisaubin Mansion, built in the early 1800's and now on the National Historic Register, was part of the underground railroad, a system set up to help run-away slaves from the south escape their owners. A tunnel from a barn led to the front of the house where hollowed pillars provided hiding places.

The area became the center of the rose growing industry in the latter part of the 19th century, with the part of Chatham Township lying between Shunpike Road and Southern Boulevard known then as Floral Hill. According to the County Heritage Commission's account, a resident revolutionized greenhouse construction and played a major role in the industry.

In that same era, several estates were established in the so- called "Gilded Age", "Dixiedale", the Kirby Estate, the estate on Buxton Road and the Dodge Estate, now known as Giralda Farms. The estate-like setting is still preserved in the Loantaka Valley surrounding the Kirby Estate.

Chatham Township remained rural until well into the 20th Century, when the population escalated very quickly from the 1950's on with construction of several subdivisions, apartment buildings and two shopping centers. The Wickam Way area was the site of the Schwartz dairy farm, with pastures and ponds edging down along the Great Swamp.

AREA NAMES

Snake Hill - the eastern steeply sloping end of Southern Boulevard is still called Snake Hill by many. Before it was straightened, it twisted and turned up the steep slope like a snake.

Fountain Hill - at the end of southerly end of Fairmount Avenue, this hill was named after the Fountain Family who lived in the 18th Century house half way up the hill.

Colony Swim Club - got its name when a number of artistic Russians built a cluster of houses or a colony in that area as an escape from New York City.

SCENIC BYWAYS

Some county roads in Chatham Township still retain their rural character and could qualify as scenic byways. Loantaka Way winds its way across the Loantaka Valley with open vistas of rolling fields. Green Village Road curves around old houses and through the village itself. River Road passes many older historic houses and open land.



Crane-Johnson house - 1767

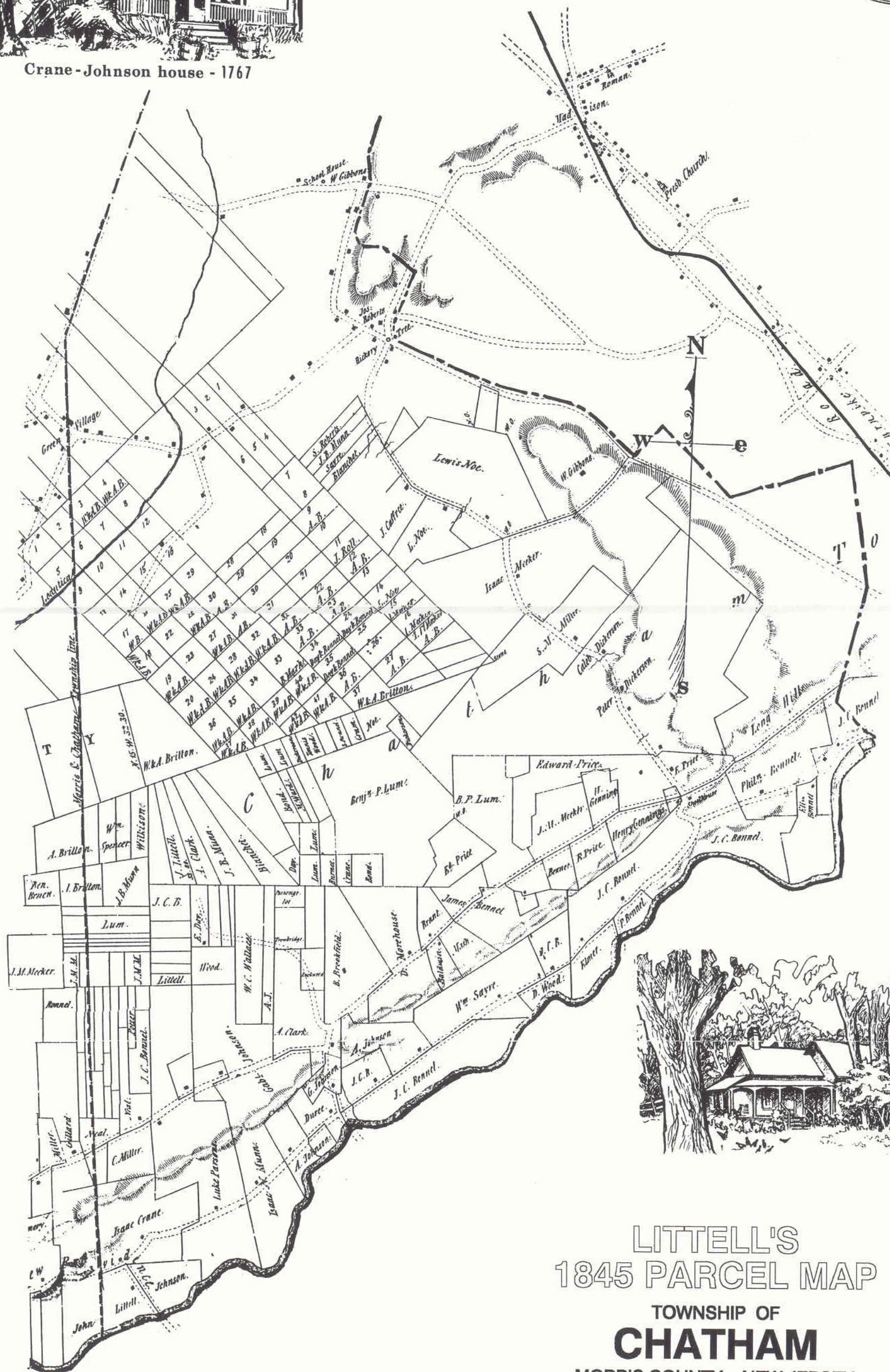

LITTELL'S 1845 PARCEL MAP

TOWNSHIP OF
CHATHAM

MORRIS COUNTY, NEW JERSEY

HISTORIC SITES SURVEY

A listing of existing historic sites prepared by the Chatham Township Historic Sites Recognition Committee is presented in Exhibit 10. Included are 56 houses and other structures.

Exhibit 10

HISTORIC SITES SURVEY

Township of Chatham
Morris County, New Jersey

Number	Site Name	Address	Date/Period	Block	Lot
1	Boisaubin	95 Treadwell Avenue	1822	143	1
2	St. Hubert's	Woodland Avenue	1900's	142	4.01
3	Loantaka Schoolhouse	245 Loantaka Way	1860's	141	9.03
4	Gibbons Horse Barn	Loantaka Way	1834	144	19
5	House	711 Shunpike Road	1790-1815	144	22
6	O'Neill House	221 Green Village Road	1770 + Revisions	135	38.01
7	J. DeHart House	330 Green Village Road	1800's	144	39.05
8	Conklin House	376 Green Village Road	Lt. 1700's/Erly 1800's	144	45
9	House	403 Green Village Road	1700's	48.18	140
10	Rome/Moore House	418 Green Village Road	1770's	144	49.01
11	Elias Boudinot House	461 Green Village Road	1760's	48.21	165
12	House	475 Green Village Road	Unknown	48.21	168
13	House	486 Green Village Road	Unknown	139	54
14	Brant House	44 Britten Road	Late 1700's	48.21	164
15	Brant Farm Barn	44 Britten Road	Unknown	48.21	164
16*	Southern Boulevard (2)	494&498 Southern Blvd.	Unknown	128	5 & 6
17	Lincoln Pierson	361 Shunpike Road	1901	96	2
18	Pierson House	16 Driftway	Unknown	96	3.01
19	J. Conklin House	204 Lafayette Avenue	1880's	85	28
20	C. Bear House	209 Lafayette Avenue	Late 1800's	78	6
21	Wm. Gibbons Estate House	15 Linden Lane	1838	96	1
22	House	296 Lafayette Avenue	1920	106	18
23	House	238 Lafayette Avenue	Unknown	83	16
24	House	25 Spring St.	1910	102.11	16
25	C. Dickinson House	154 Southern Boulevard	1853-1868	102.11	5
26	Lewis Noe House	184 Southern Boulevard	1770	102.11	23
27	House	11 Garden Street	1930's	111	42
28	House	137 Southern Boulevard	1800's	48.04	26
29	Dickinson Homestead	122 Southern Boulevard	1785	70	6
30	Edward Price Homestead	55 Southern Boulevard	1840	48.01	13

* Vernacular Cottages

Exhibit 10 Continued

HISTORIC SITES SURVEY

Township of Chatham
Morris County, New Jersey

Number	Site Name	Address	Date/Period	Block	Lot
31	Baldwin/Price Homestead	48 Southern Boulevard	Late 1700's	68	1
32	Estate House	30 Buxton Road	Early 1900's	48.21	164.05
33	Carriage House	59 Buxton Road	Unknown	62	102
34	House	361 Fairmount Avenue	1920	67	6
35	Mt. Vernon School (Red Brick Schoolhouse)	24 Southern Boulevard	1860	67	1
36	House	293 Fairmount Avenue	1920's	67	14
37	Dixiedale Estate	Hillside-River Road	1916	66	1
38	Dixiedale Cottage	Hillside Avenue	Mid 1800's	66	1
39	J.C. Bonnell House	392 River Road	1800's	62	87
40	JC Bonnell House	440 River Road	Pre 1845	62	76
41**	Wm. Sayre Farm	450 River Road	Unknown	62	75
42	H. Muchmore House	471 River Road	1870's	63	18
43	T. Dehring House	537 River Road	1880's	63	11
44	Soule House	609 Fairmount Avenue	Mid 1800's	62.12	1
45	Brant House	686 Fairmount Avenue	Pre 1845	60	18.01
46	Livingston Farm	49 Mountainview Road	1800's	54	1
47	Johnson House	805 Fairmount Avenue	1770 & 1800's	62.08	19
48	Duree House (Walker House)	686 River Road	1767	39	64
49	Isaac Clark House	788 River Road	1773	39	1
50	House	25 Ridge Road	1900's	6	5
51	House	602 Fairmount Avenue	Unknown	17	84
52	Conger House	208 Southern Boulevard	1854	102.10	2
53	House	150 Spring Valley Road	Unknown	139	10
54	House	77 Fairview Avenue	Unknown	78	7
55	Old Noe House	138 Noe Avenue	Unknown	102.06	34
56	House	204 Lafayette Avenue	Unknown	85	29

** Assumed location based on 1845 parcel map

Source: Morris County Heritage Commission Study/Chatham Twp. Historic Sites Recognition Committee
and 1999 Township Tax Records

Revised: August 12, 1999

LEGEND:



HISTORIC SITE
NUMBERS KEYED TO TABLE

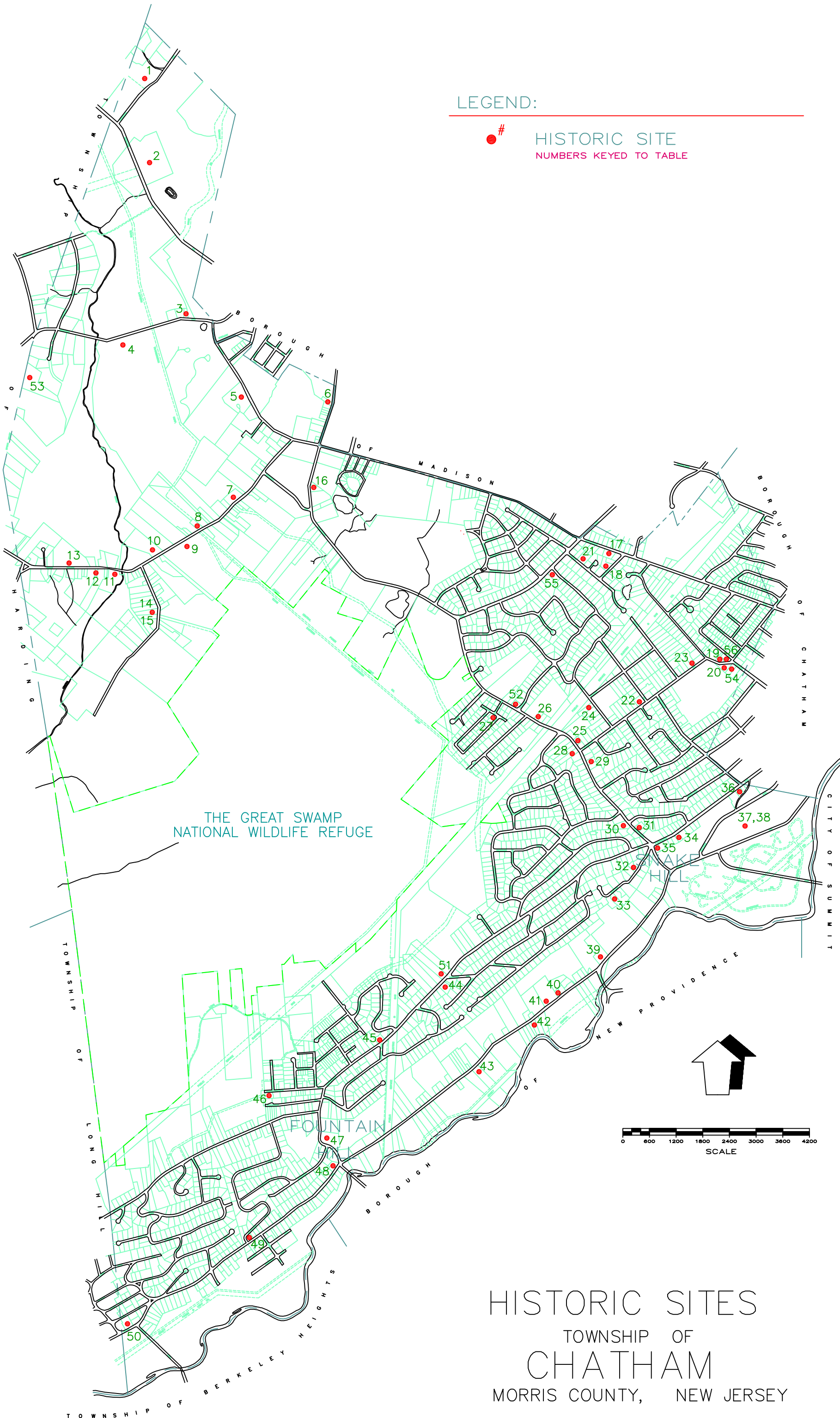

HISTORIC SITES
TOWNSHIP OF
CHATHAM
MORRIS COUNTY, NEW JERSEY